

GROUNDWORK REPORT



Nourish: Edward Woods

Stage 1 Consultation Summary

December 2019

Contents

1. Executive Summary.....	4
2. Introduction.....	3
3. The Consultation Process.....	4
4. Recommendations.....	14
5. Next steps.....	15
Appendix 1: Concept proposal design survey – May 2017.....	16
Appendix 2: Concept proposal design survey 2 – September 2017.....	19
Appendix 3: Final sketch design survey – December 2017.....	22
Appendix 4: Concept proposal design consultation board – May 2017.....	25
Appendix 5: Concept proposal design consultation board 2 – September 2017.....	26
Appendix 6: Final sketch design consultation board – December 2017.....	27

Table of figures

Figure 1: Proposed sites for greening interventions.....	6
Figure 2: Current images of impermeable or underutilised land.....	7
Figure 3: Engagement approach.....	8
Figure 4: Participant Ethnicity	9
Figure 5: Q2. How often do you/your family use the green spaces on the estate?.....	10
Figure 6: Q4. What would you like the green spaces between the blocks to be used for?	11
Figure 7: Q7. Would you be interested in attending food growing or gardening	11
Figure 8: Q8. Do you have experience of any problems with either noise or air.....	12

1. Executive Summary

As part of the Nourish programme, Groundwork London's Landscape Architecture team conducted a feasibility assessment of Edward Woods estate's green spaces to identify potential areas that could be improved. Following this, Groundwork London Communities team undertook consultation with the residents at Edward Woods Estate to discern greening priorities for the estate. The consultation process comprised of a number of methodologies: open comment consultation stalls, community mapping exercises, round table discussions and surveys. To focus the engagements, we identified local stakeholders and made contact with them to identify focus groups. Groundwork London consulted with over 110 residents directly over the consultation activities with 22 residents completing the survey. The survey sought to identify the green space users at Edward Woods, understand the estate from their perspective and ascertaining their priorities for green space improvements.

A number of cross cutting themes emerged through the engagement activities, primarily a strong interest from residents in growing/gardening activities in the Edward Woods area. This reflected broader local priorities and current activities, such as the food programmes and cooking classes run by the Edward Woods Community centre. There is a clear appetite for food growing as demonstrated by the nascent allotment group and the recently rejuvenated, resident-led growing beds on Swanscombe Road. Residents and other users discussed the importance for ongoing maintenance issues and suitable funding for this.

Whilst there are a number of play areas in Edward Woods Estate there was a shared interest for natural play and alternative forms of play, such as a skate park/dirt bike park. There was a perceived lack of activities for youth as most amenities catered for young children.

Edward Woods Estate boasts substantial green space and planting variation in the northern Norland green space however the southern space, adjacent to the Community centre, was seen as lacking colour. Respondents expressed a desire for colourful, sensory planting that would benefit residents, commuters and bolster biodiversity. Beehives were mentioned on several occasions, with suggestions that they would increase the biodiversity of the area whilst providing eco-system services such as well-being benefits.

Neither residents nor users of Edward Woods, nor commuters passing through the area reported water pooling or flooding issues. Despite this, a number of those engaged in the consultation stalls approved of the precedent images illustrating wildflower/SUDs work and appreciated their benefit. The findings from the consultation will inform initial design work. This design work will need create space where residents can engage in gardening, food growing and social activities as well as infrastructural developments that bolster biodiversity whilst capturing rainwater through sustainable urban drainage solutions.

2. Introduction

Nourish is a large scale project being delivered as part of the Good Growth Fund, a Mayor of London initiative to promote sustainable development of London. The London Borough Hammersmith and Fulham is working with Groundwork London to talk to residents, community organisations and businesses about how we can enhance housing estates using retrofit SuDS, Green Infrastructure and community food growing.

SUDs have the potential to play an important role in reducing the likelihood of flooding and stress on London's sewer network by capturing rainwater and allowing it to naturally soak back into the ground. SUDs work by channelling water into swales, diverting it away from drains. This can be useful during periods of high rainfall when the risk of flooding and water pooling is increased. SUDs plans are often combined with biodiversity improvements, such as wildflower meadows and planting to provide habitats for wildlife.

The project was awarded funding to run community consultation, develop designs for the space and complete the capital improvement. Funding has come from Thames Water, Section 106 and Greater London Authority.

The aims of the projects are to:

- provide residents of Edward Woods Estate with opportunities to inform the design of their communal green spaces; and
- deliver a high quality, capital improvement project which will ensure that may serve to provide improved opportunities for social interactions and activities for the resident enable them to use the garden for gardening, food growing, play and social activities.

2.1 The estate and surrounding area

Edward Woods Estate is a large estate in the London Borough of Hammersmith & Fulham (LBHF).

Edward Woods Estate accommodates around 750 properties all of which are in close proximity, and have access to, the aforementioned green spaces.

2.2 The proposed space for development

The proposed sites were identified through a feasibility study, carried out by GW Landscape Architects, identifying suitable sites for different greening interventions, (see map, below).

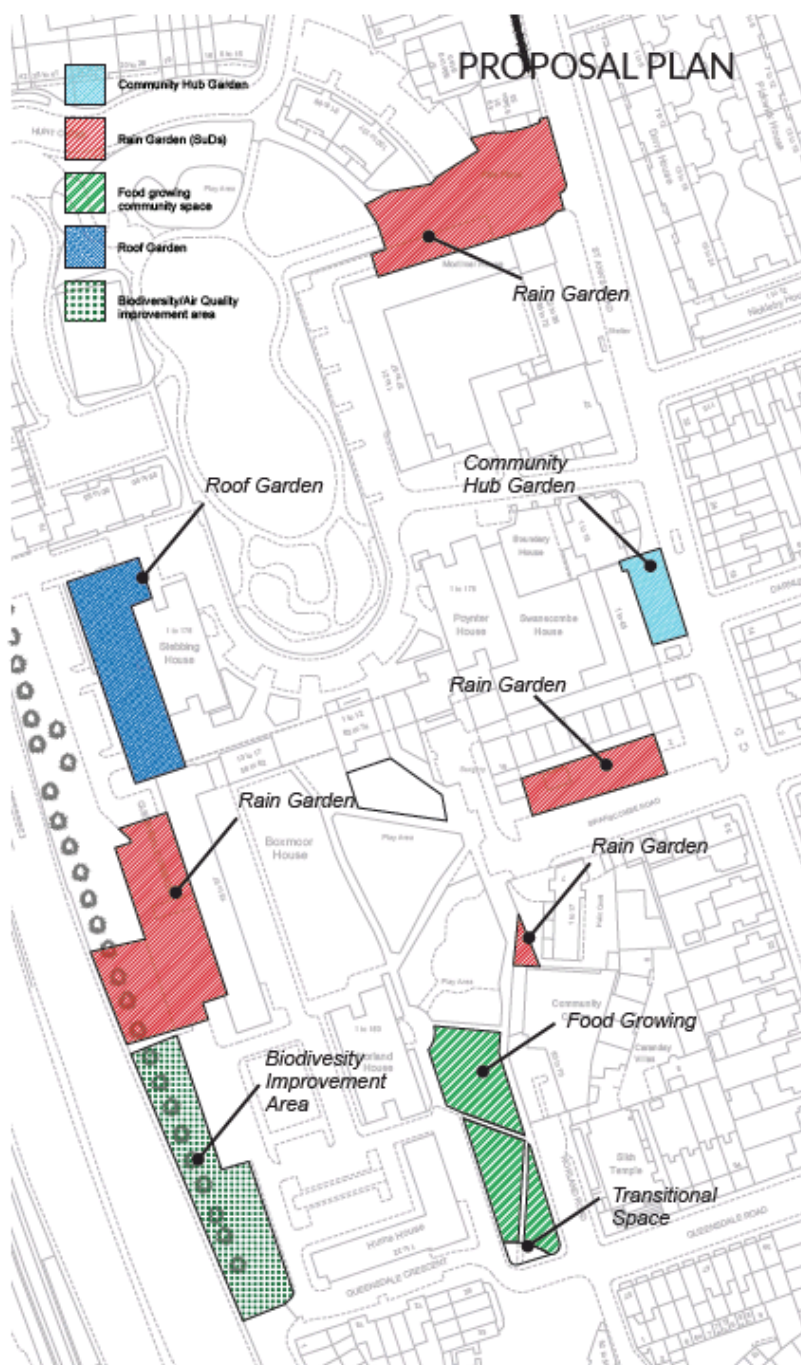

Figure 1: Proposed sites for greening interventions



Figure 2: Current images of impermeable or underutilised land

Whilst some areas, such as the large park at the Northern end of the estate are regularly and well maintained there are a number of other sites which are currently neglected and unused, requiring significant landscaping improvements.

3. The Consultation Process

In order to generate ideas for the new space, Groundwork London's engagement approach was to conduct a programme of varying consultation activities to cover a broad range of stakeholders:

Activity	Audience/Target Numbers	Dates
Update webpage	All Stakeholders.	July
Survey (online and hard copy)	Residents, & Community Organisations	September to December
Posters To advertise survey and engagement stall/event	Residents	October
Community Meeting	Edward Woods Community Centre	October
Trip to Queen Caroline Estate and meeting with Edward Woods TRA	Tenants and Residents Association	January
Estate Mapping Exercise	Edward Woods residents and other users of the public spaces	October
Engagement Pop Ups x 3	Presence at high footfall local events - Residents, Visitors, Community Organisations. 15 people engaged per pop up	October
Community Event	Residents, Visitors, Community Organisations. 40 people engaged	November

Figure 3: Engagement approach

Engagement delivery.

- May - Public engagement began with 2 meeting with residents in May where Groundwork London partnered with UK Harvest to run activities outside the Nourish Hub. Community mapping exercises and food growing activities were run.
- 1st October - Focused engagement was run with residents in the sheltered housing unit where residents used an image board and a map of the estate to identify areas with greening potential. Surveys were conducted with the residents to understand estate wide issues and assess personal information such as feelings of isolation. There was ample time allowed for open discussion around resident aspirations for the area.
- 10th Oct / 9th Nov - Public consultations featuring image boards, mapping exercises and open comment were carried out on Norland open space, capturing commuter traffic, users of the community centre and residents. (Communication materials were produced and a round of whole estate publicising with posters was carried out to publicise these events).

- 2nd / 22nd Oct - Focus groups were carried out at the Edward Woods community centre to understand existing provision on the estate and demand for further greening. Image boards were used to guide the conversation.
- Pending - Due to changing leadership of Edward Woods' TRA, the planned site visits and consultation activities have been postponed to their next meeting
- Throughout, image boards, and survey information was made available in public locations in Edward Woods Community Centre.

Groundwork London consulted with over 110 residents directly over the consultation activities with 22 residents completing the survey.

3.1 Consultation Survey

Groundwork London has undertaken consultation with the residents, and users of, Edward Woods Estate by survey and image boards from September to December 2019 and given residents opportunities to provide feedback on mapping boards.

3.3 Consultation Findings

Participant Information

Of the participants who were engaged across the survey, 50% were female, 40% were male and 10% did not state their gender. The majority of respondents did not disclose their ages although through delivering public engagement across a range of dates, locations and times we were able to engage people of all ages. Figure 4 displays the ethnicity of the resident participants.

Figure 4: Participant Ethnicity

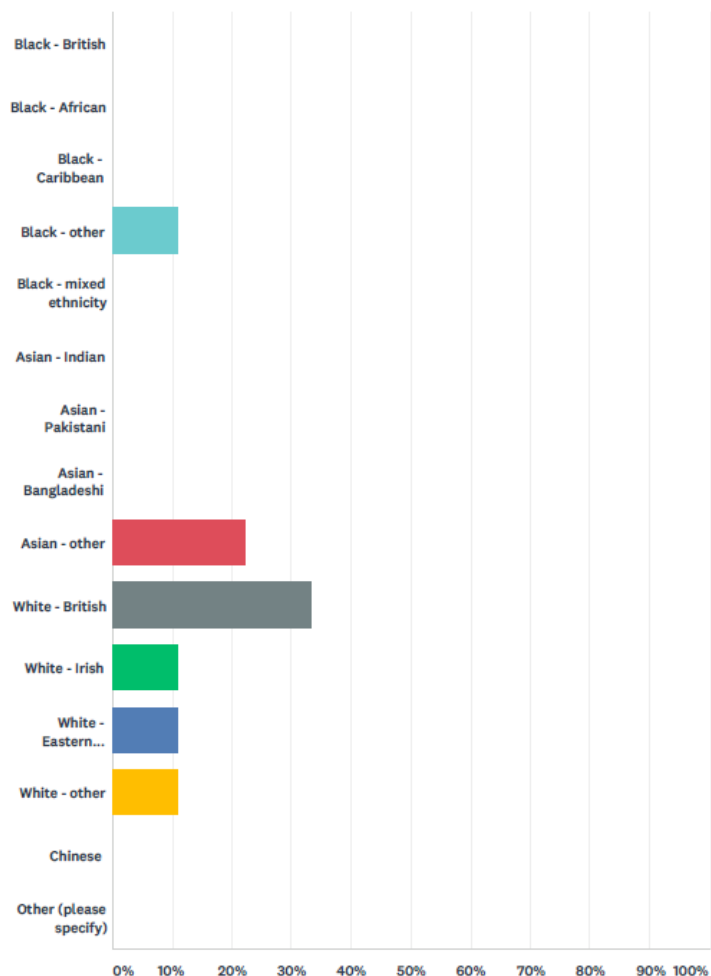

Survey Responses

Section 1: Your Estate

Of those surveyed, 45% of respondents were residents of the Edward Woods estate.

Most residents reported some use of the green spaces and commented that there was potential for improvement. Of those who used the spaces, the majority described using the northern park (Q3) or 'main park' adjacent to Rifle place.

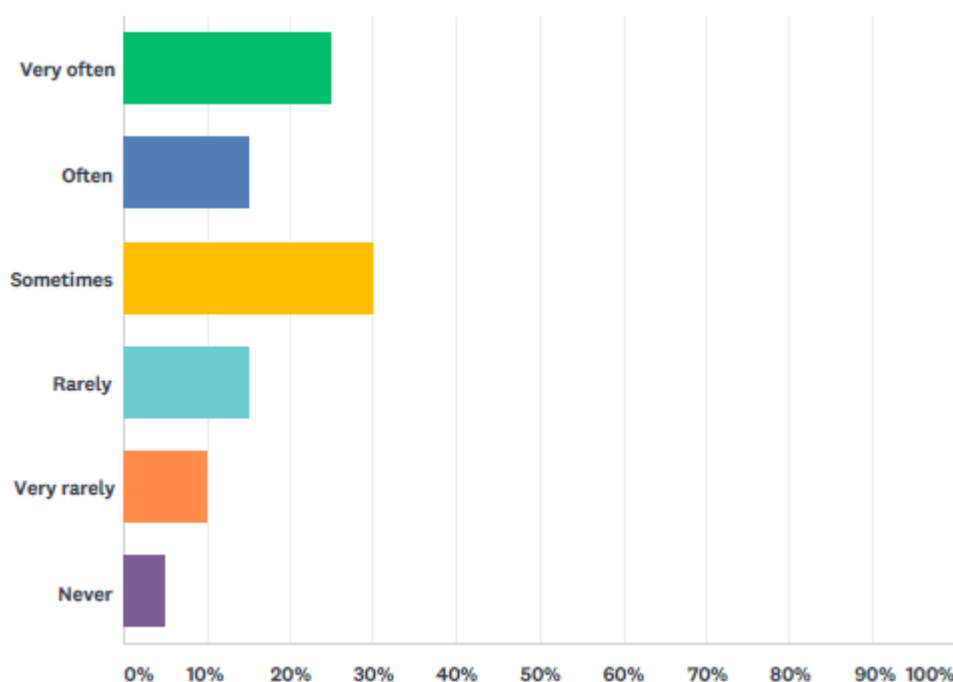

Figure 5: Q2. How often do you/your family use the green spaces on the estate?

Having viewed the image boards the vast majority of respondents stated preferences for food growing and gardening activities with additional interest in places to sit and relax. Anecdotally, a number of unusual suggestions arose from more detailed discussions including reference to the 'health benefits of bee keeping/hives', a child's longing for a 'dirt bike course' and one mention of an 'outdoor gym'. (See figure 6).

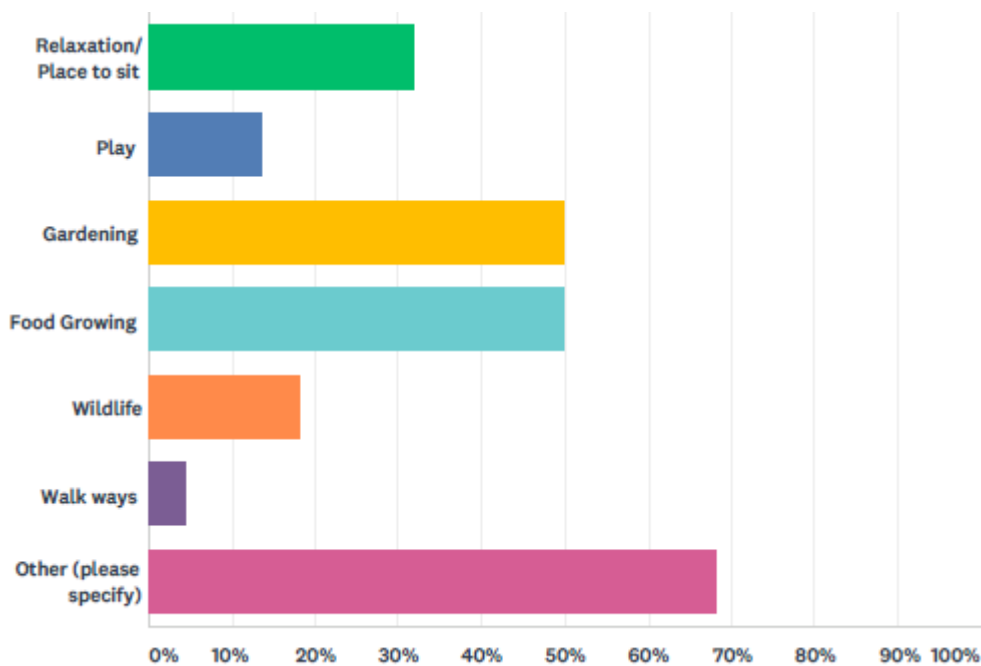

Figure 6: Q4. What would you like the green spaces between the blocks to be used for?

When recipients of the survey were asked whether they would be interested in attending food growing or gardening workshops? (Q7), there was an overwhelming positive response. 100% of those who answered the question replied “Yes”.

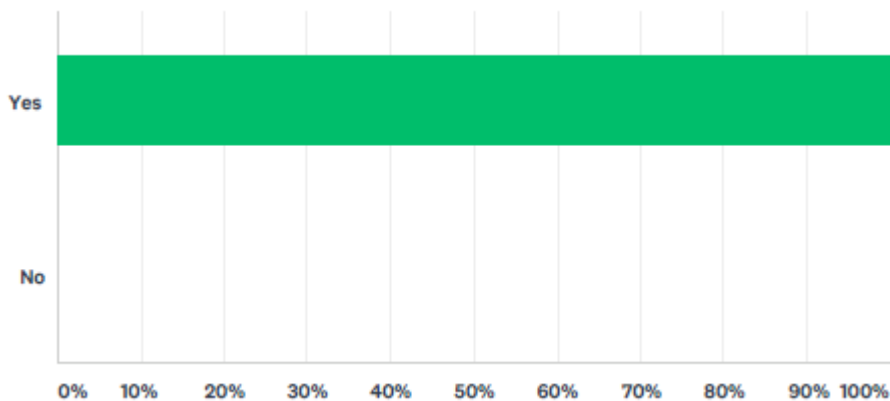

Figure 7: Q7. Would you be interested in attending food growing or gardening

Site issues

When questioned about whether there were “any parts of the estate where you've experience flooding, water pooling or drains overflowing?” residents could not identify any. One resident quoted [Verbatim], “Me? Erm no, not me son. 22 years of living on this estate and I've never seen nothing!”

A number of anti social behaviour issues were cited, specifically revolving around drug dealing. There were a couple of mentions of vandalism, littering and a flower plant being broken. However, there were no other mentions of public property being broken. It was advised that improvements should be overlooked or on sight-lines from resident windows so that any crime could be observed and reported easily.

When questioned about Air and Noise pollution the responses were polarised into those who very rarely experienced either to those who felt that they experienced these issues 'very often'. Whilst it is dangerous to assume a correlation it could be possible that those living closest to the A3320 (such as the blocks adjacent to Queensdale Crescent) are more likely to suffer from both.

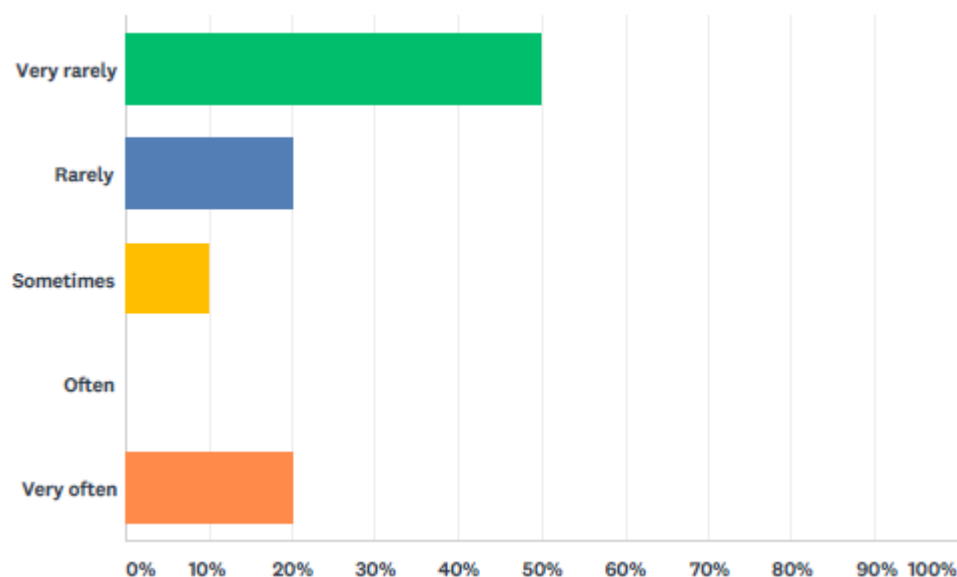

Figure 8: Q8. Do you have experience of any problems with either noise or air pollution on Edward Woods estate?

Respondent Data / representation

Through our engagement we were able to identify and talk to a broad range of people as illustrated in the 'Participation information'. This may help to explain the range of answers about their own health and feelings of isolation

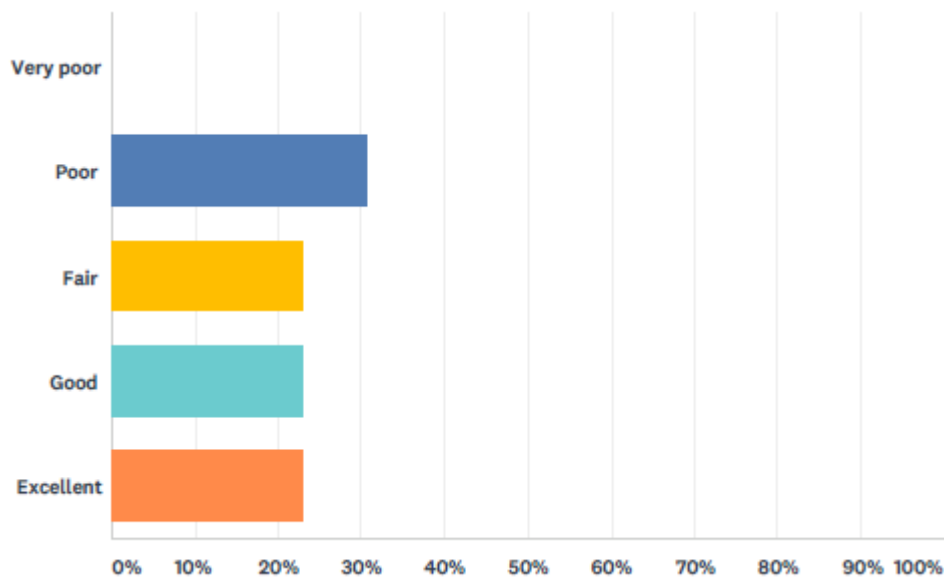

Figure 9: Compared to people of your own age, in the last 12 months how would you say that your health has been?

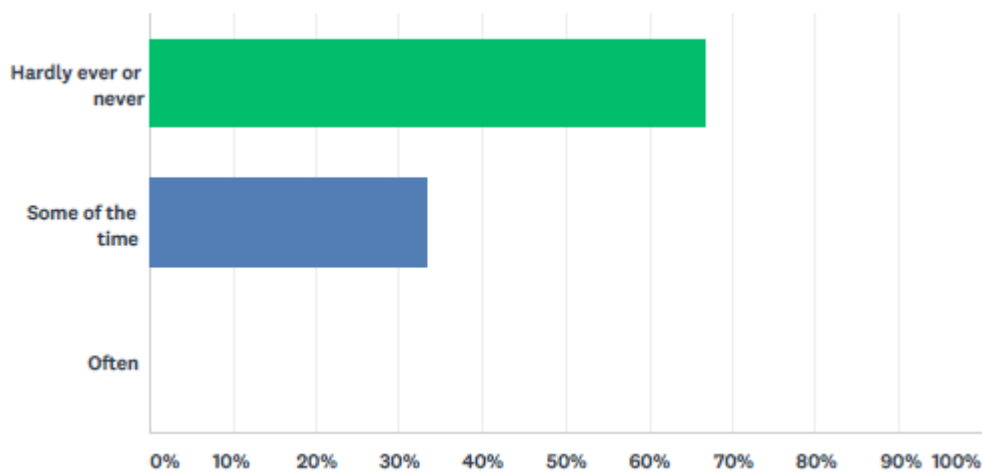
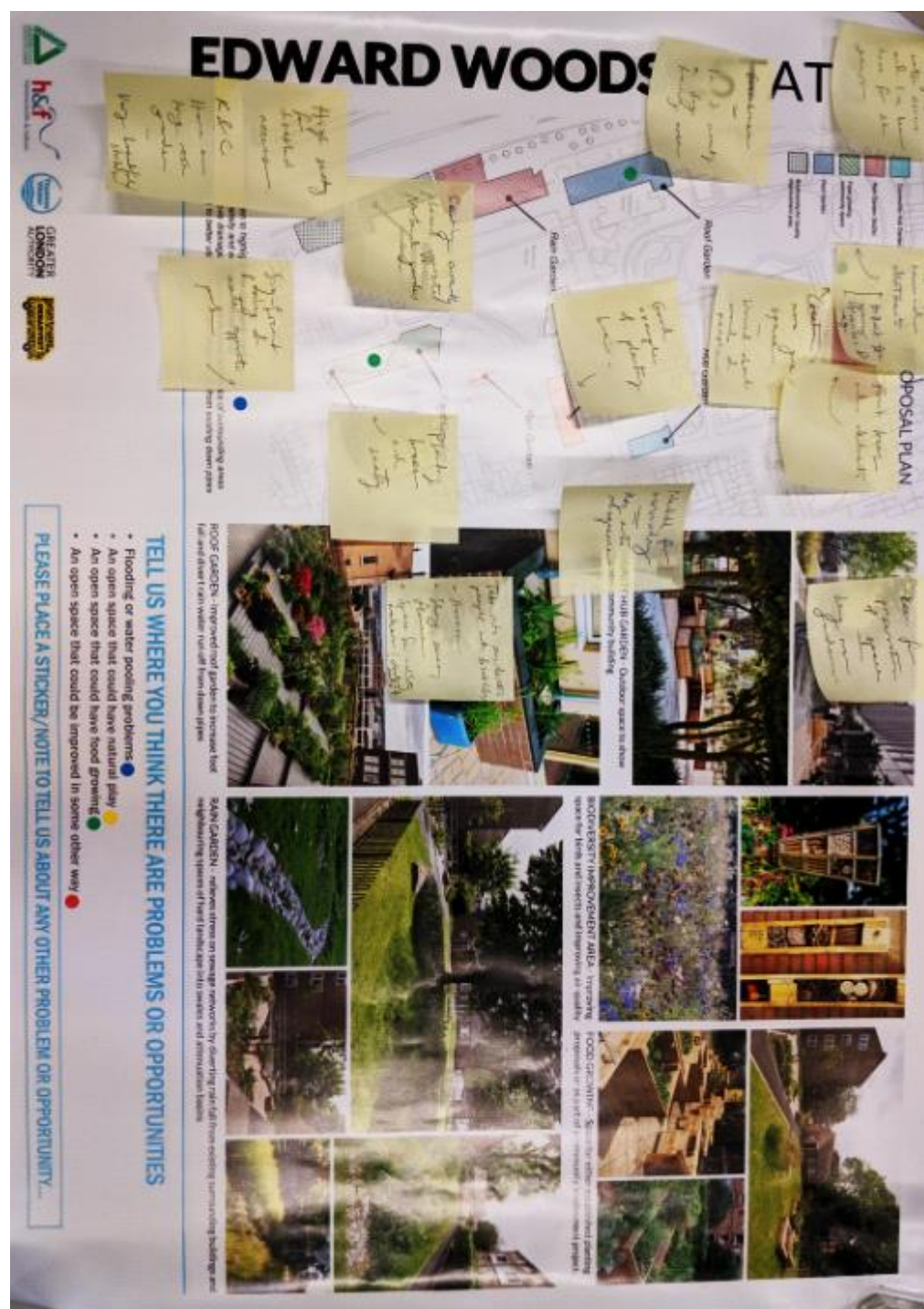

Figure 10: Q11 How often do you feel lonely or isolated?

Using the Edward Woods estate map, residents posted open comments to indicate problems and opportunities as well as illustrating preferences on the following options for greening improvements.



As a result of this mapping exercise it was evident that there were a number of greenspace improvements that would improve the area. The majority centred on the residents' desire for food-growing/planting amenities to provide opportunities for activities regardless of age or ability.

Emergent themes from the Edward Woods consultation were as follows:

Gardening

Strong interest from residents in growing/gardening activities in the Edward Woods area. Food growing featured most prominently and reflects broader local priorities i.e food programmes run by the Edward Woods Community centre and cooking classes for all ages from the same provider. There is a clear appetite for food growing as demonstrated by the nascent allotment group operating next to Norland house and the recently rejuvenated, resident-led growing beds on Swanscombe Road. This would complement the ongoing and planned work at the Nourish Hub. When discussing growing beds, maintenance issues were raised and it was requested that funding is earmarked for the ongoing maintenance and care of beds by community groups.

Play

Whilst there are a number of play areas in Edward Woods Estate there was a shared interest for natural play and alternative forms of play, such as a skate park/dirt bike park. The young people engaged mentioned that there was at present a lack of activities for their age range as most amenities catered for young children.

Biodiversity

Whilst Edward Woods Estate boasts substantial green space and planting variation in the northern Norland green space. The southern space adjacent to the Community centre was seen as lacking colour. Additionally, beehives were mentioned on several occasions, with suggestions that they would increase the biodiversity of the area whilst providing eco-system services such as well-being benefits.

Flooding / Waterpooling

Neither residents nor users of Edward Woods, nor commuters passing through the area reported water pooling or flooding issues. Despite this, a number of those engaged in the consultation stalls approved of the precedent images illustrating wildflower/SUDs work and appreciated their benefit.

The findings from the consultation will inform initial design work. This design work will need create space where residents can engage in gardening, food growing and social activities as well as infrastructural developments that bolster biodiversity whilst capturing rainwater through sustainable urban drainage solutions.

5. Next steps

5.1 Capital works

Groundwork London will use the consultation report alongside the feasibility report to inform future design work and develop 2nd stage consultation material. In the 2nd stage of the project Groundwork London Communities team will present residents and other stakeholders of Edward Woods Estate with developed design (RIBA stage 3) to ascertain final amendments before the technical drawing stage (RIBA stage 4). Following this we will look to tender and obtain quotations for the capital works and will appoint a suitable contractor.

6. Appendix

6.1 Appendix 1: Edward Woods Board for Consultations

EDWARD WOODS ESTATE



PROPOSAL PLAN

Legend:

- Community Hub Garden
- Rain Garden (Buffy)
- Food growing community space
- Rain Garden
- Biodiversity/Air Quality Improvement Area
- Roof Garden
- Food Growing
- Transitional Space
- Rain Garden

Proposal:

- Community Hub Garden to highlight new community centre
- Nature area for biodiversity and air quality improvements
- Rain gardens to improve drainage efficiency and improve aesthetics of surrounding areas
- Improved rain garden to better utilise the space and divert rain off from existing down pipes



COMMUNITY HUB GARDEN - Outdoor space to show case the new community building

BIODIVERSITY IMPROVEMENT AREA - Improving space for birds and insects and improving air quality

FOOD GROWING - Space for either established planting proposals or as part of a community involvement project

ROOF GARDEN - Improved roof garden to increase foot fall and divert rain water run off from down pipes

RAIN GARDEN - relieves stress on sewage networks by diverting rain fall from existing surrounding buildings and neighbouring spaces of hard landscape into swales and attenuation basins

TELL US WHERE YOU THINK THERE ARE PROBLEMS OR OPPORTUNITIES

- Flooding or water pooling problems
- An open space that could have natural play
- An open space that could have food growing
- An open space that could be improved in some other way

PLEASE PLACE A STICKER/NOTE TO TELL US ABOUT ANY OTHER PROBLEM OR OPPORTUNITY...



GROUNDWORK

CHANGING PLACES CHANGING LIVES

Rain Garden & Food Growing Examples



RAIN GARDEN - relieves stress on sewage networks by diverting rain fall from existing surrounding buildings and neighbouring spaces of hard landscape into swales and attenuation basins

FOOD GROWING - Space for either established planting proposals or as part of a community involvement project.

Biodiversity, Nourish Hub & Roof Gardens Examples

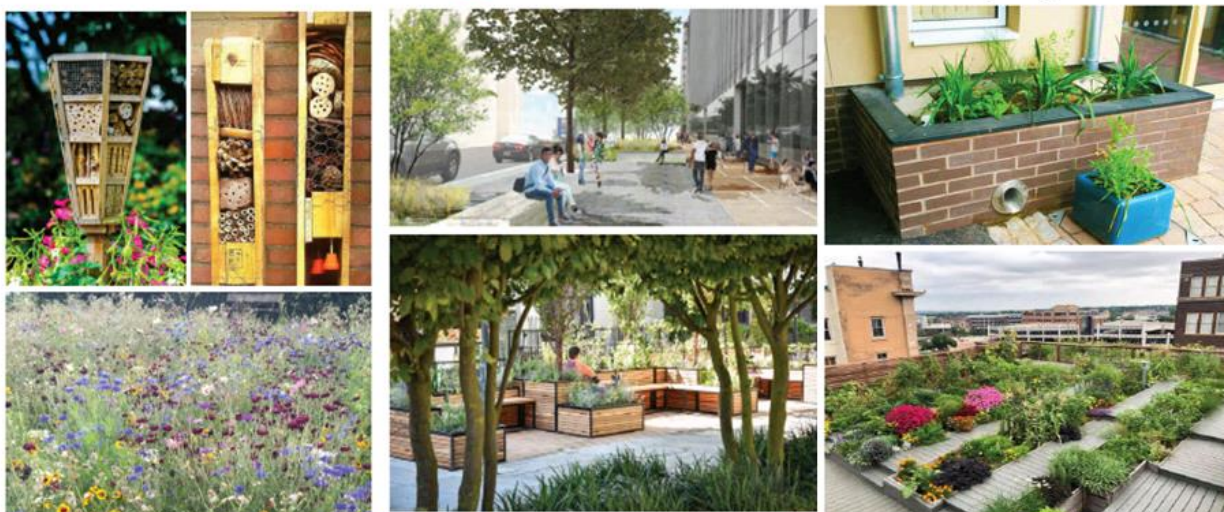

BIODIVERSITY IMPROVEMENT AREA - Improving space for birds and insects and improving air quality

COMMUNITY HUB GARDEN - Outdoor space to show case the new community building

ROOF GARDEN - Improved roof garden to increase foot fall and divert rain water run off from down pipes

6.3 Appendix 3: Consultation Publicity

Contact Details

This report was written by David Cordell, Groundwork London.

Groundwork London is one of a federation of 50 Groundwork Trusts operating in the UK. We are a charity providing environmental regeneration in deprived areas, and have been delivering sustainable improvements to communities in West London since our foundation in 1994.

Groundwork's projects cover a wide range of disciplines; from regenerating neglected land for community use to working with local businesses.

We work in partnership with local councils, housing associations, tenant and resident associations, schools, community groups, voluntary organisations, regeneration agencies and the private sector to deliver our projects. By involving a wide range of local stakeholders, we work to create a sense of community ownership of our projects that will ensure their impact is long lasting.

The Groundwork London team offers a wide range of skills and experience, including community development, landscape design and consultation. Our multi-disciplinary and highly motivated team also contains specialists in youth work, education, nature conservation, business development, project management, marketing and fundraising.

Contact Groundwork London (West Office) at:

Unit BMLG.11

Barley Mow Centre

10 Barley Mow Passage

London

W4 4PH

Telephone: 020 8743 3040