

EDWARD WOODS ESTATE IMPROVEMENTS

PROPOSALS FOR CONSULTATION

This document forms part of a community consultation exercise we are running to help us develop design proposals for the Edward Woods Estate.

Please read this document & complete the accompanying questionnaire at:

<https://www.surveymonkey.com/r/EdwardWoodsEstate>

please send us your comments by: 30th June 2021

COMMUNITY CONSULTATION: Having your say

WHAT IS NOURISH?

Nourish is a scheme to transform Edward Woods estate's green spaces, led by the Socio-environmental charity Groundwork London (GWL). LBHF have commissioned GWL to talk to residents & community groups across the estate to understand what green space issues the estate currently faces, and what improvements they would like to see to remedy them.

WHY CONSULT?

Consultation will help inform the design outcomes so that they better suit both site and users. Previous rounds of consultation have helped identify suitable sites, & priorities for local residents

CONSULTATION TO DATE

- 2019: a series of consultation events - pop-up conversation stalls, focus groups and surveys
- 2020: remote & online consultations during the pandemic.
- A summary of findings from previous consultation can be found at: www.groundwork.org.uk/projects/nourish/

TIMELINE FOR IMPROVEMENTS:

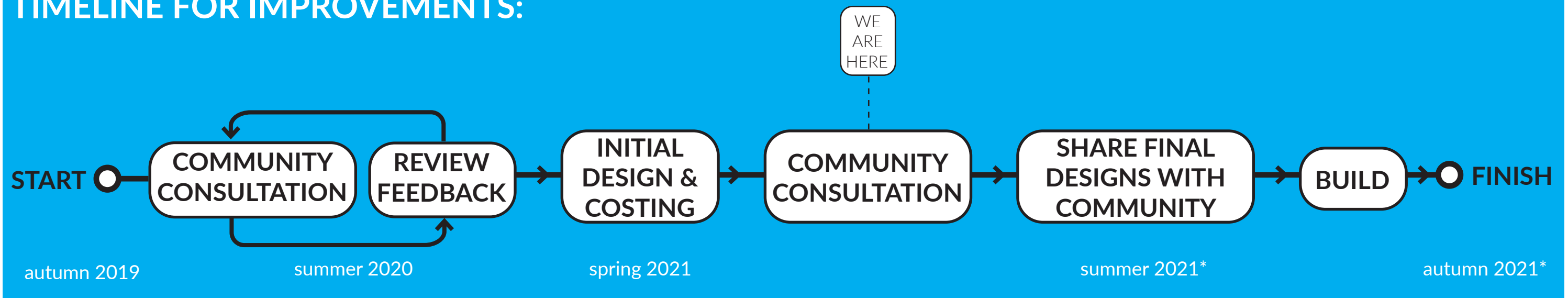

*timing subject to lifting of lockdown restrictions

CONTACT DETAILS

For more information please contact Harjinder Nijjar at harjinder.nijjar@groundwork.org.uk or call 07999 408188

SPRING/SUMMER 2021

EDWARD WOODS ESTATE IMPROVEMENTS



PROPOSED SITES

PROPOSED SITES (KEY):

- Priority site (community centre)
- Improvements to existing planting

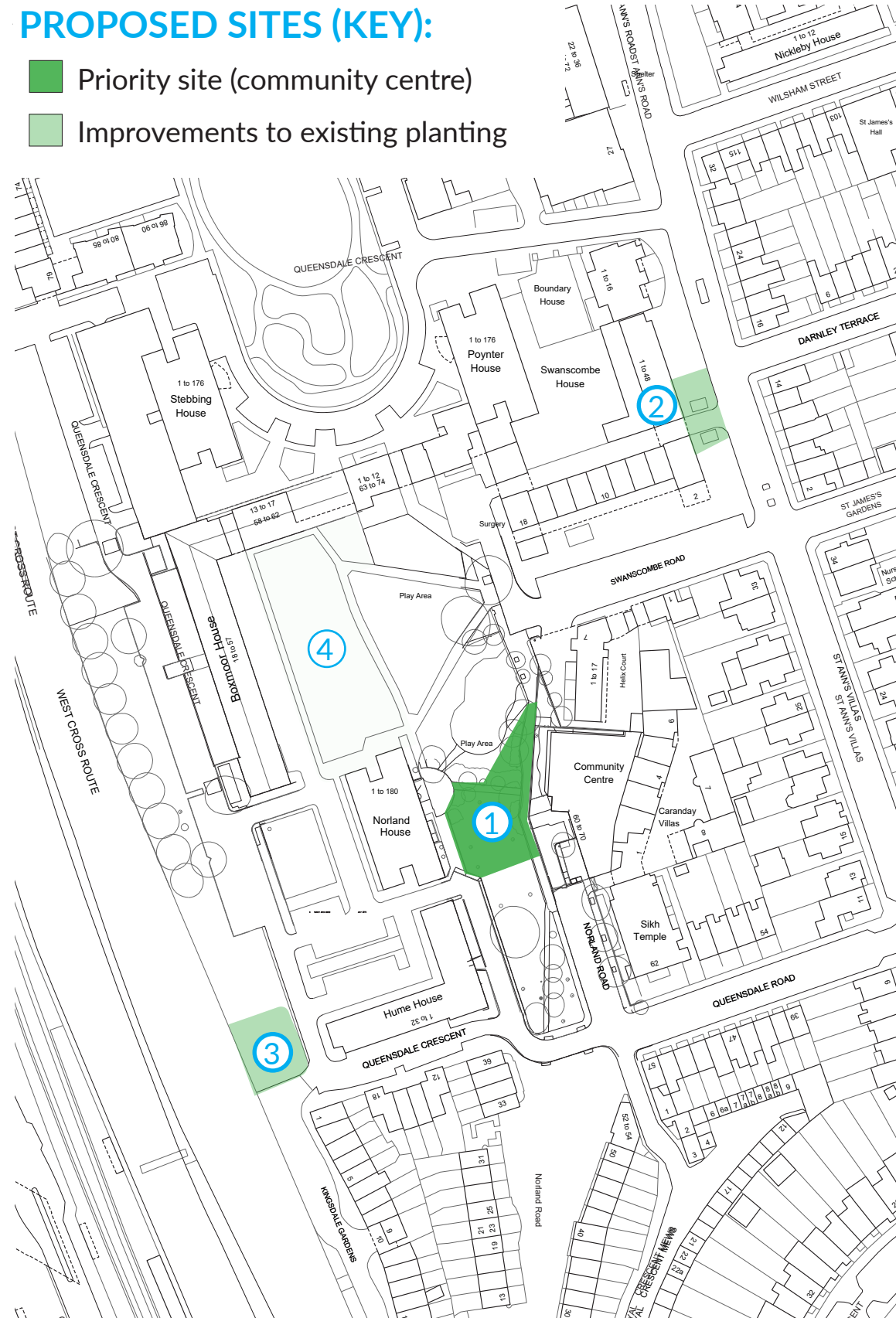

The improvements at Edward Woods Estate focus on a series of spaces throughout the estate which were identified (following initial consultation) as being potentially suitable for improvement. Previous consultation identified priorities for each areas, as follows:

- ① **Community Centre & environs** - Priority site identified in last round of consultation. Identified as best site for new community garden and improvements to public realm.
- ② **Nourish Hub** - Proposed improvements to existing planting beds
- ③ **Land adjacent to Hume House** - proposed tree planting to help boost biodiversity and develop green barrier to road pollution from adjacent elevated west Cross Route
- ④ **Boxmoor House greenspace** - Previously identified as suitable for improvements, site is currently occupied by other contractors who are undertaking urgent works for LBHF. As a result of these urgent works we are currently unable to progress works on this site.

SPRING/SUMMER 2021

EDWARD WOODS ESTATE IMPROVEMENTS



COMMUNITY CENTRE

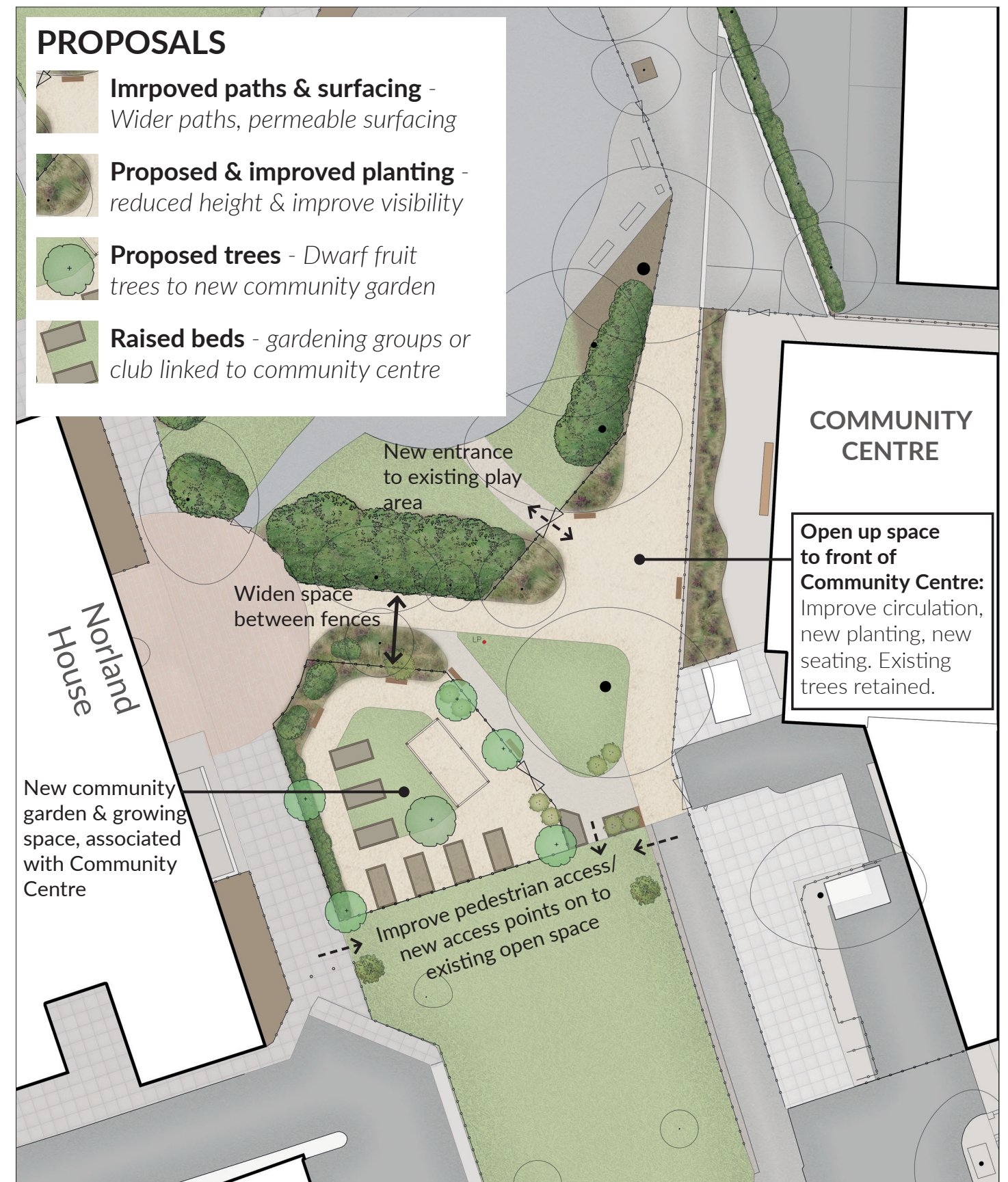
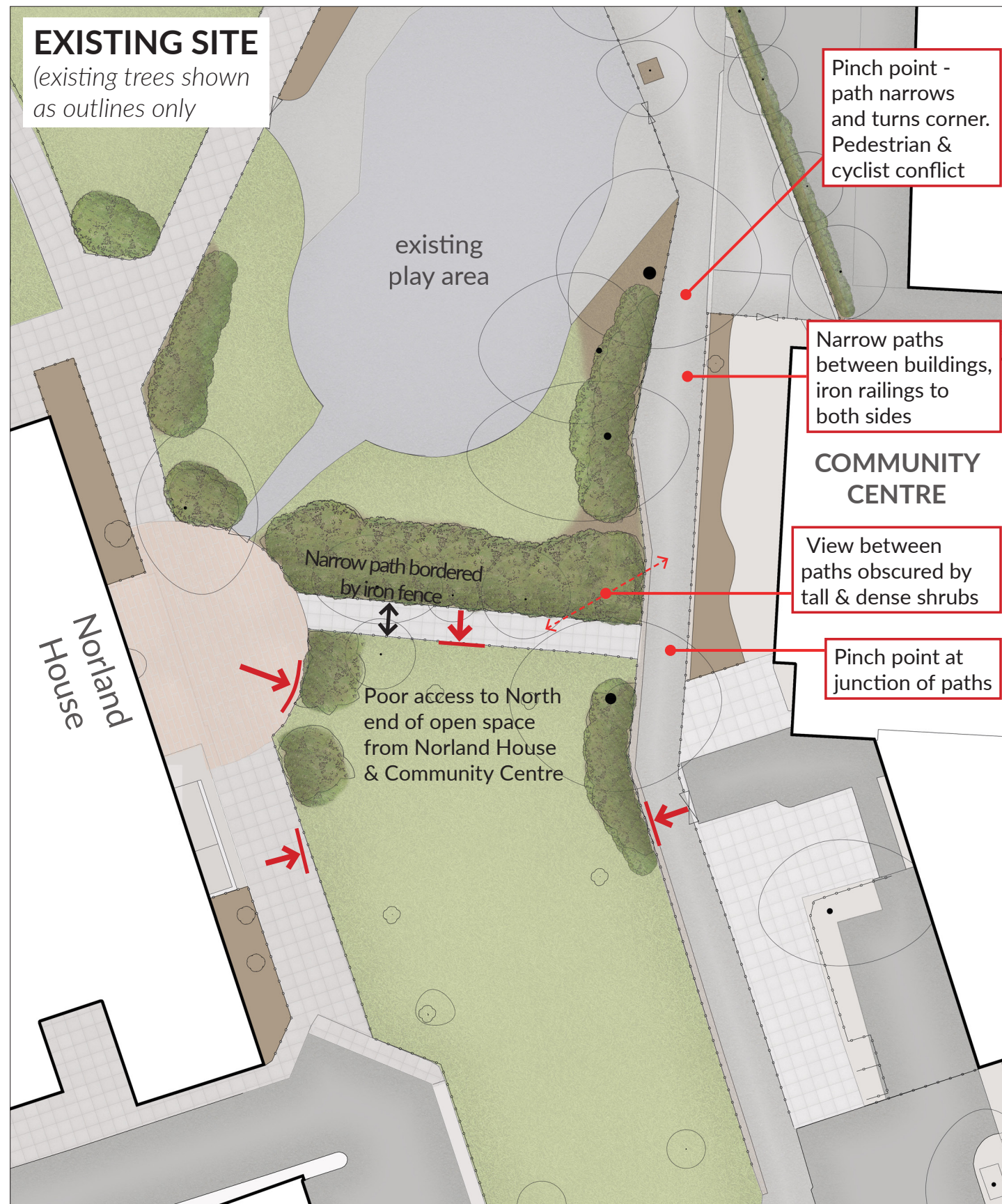

SPRING/SUMMER 2021

EDWARD WOODS ESTATE IMPROVEMENTS



COMMUNITY CENTRE: Proposals

NEW GARDEN & GROWING SPACE

Previous consultation identified strong interest in a new communal growing space close to the Centre:

1. Raised beds
2. Fruit trees & bushes
3. Shelter & social area for group activities.
4. Ornamental planting at edges to link to other adjacent planted areas.
5. Secure fencing to edge
6. Space for relaxing

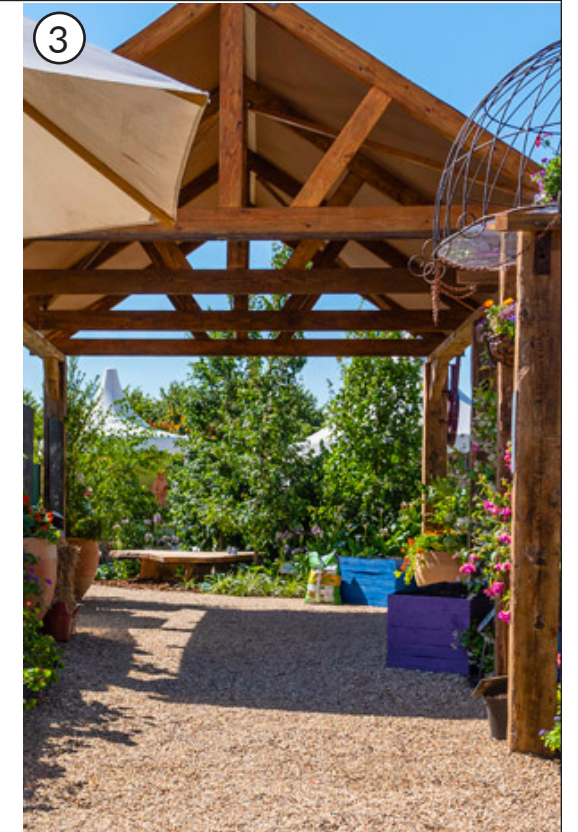

IMPROVE PEDESTRIAN ACCESS & EXPERIENCE

- Opening up the space in front of the community centre (new mini 'square')
- Widen paths and reduce pinch points.
- Amend existing shrubs (reduce height, remove or replace) to improve sight lines between paths
- Improved seating
- New paved surfaces



IMPROVED PLANTING ④

New beds contain mixed herbaceous & low shrub planting. Provides seasonal colour and improves visual links between paths (no longer blocked by high, dense shrubs). New plants added into existing Community centre bed to tie existing in to new planting areas.



NOURISH HUB (St Anne's Road)



Previous consultation revealed that the refreshment of existing planting beds was a priority for residents. The redevelopment of the nourish Hub (run by UK Harvest) provides an opportunity to link the theme of edible planting into existing ornamental areas.

Proposed planting:

- Colourful, drought-tolerant species
- Wildlife-friendly planting
- Small flowering shrubs or trees
- Include ornamental edible species (link to activities run by UK Harvest in Nourish hub)

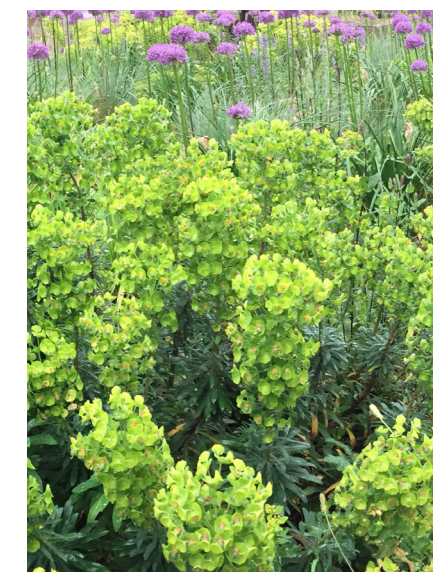
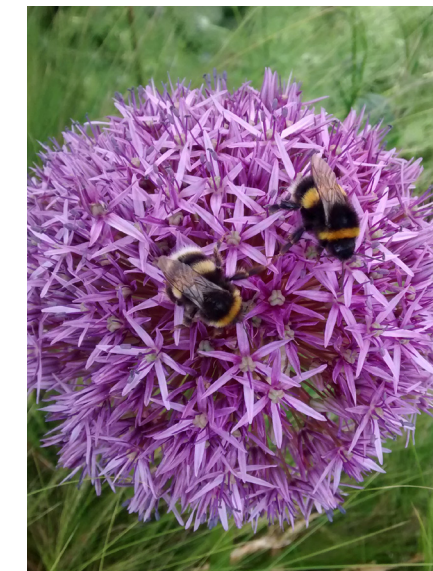
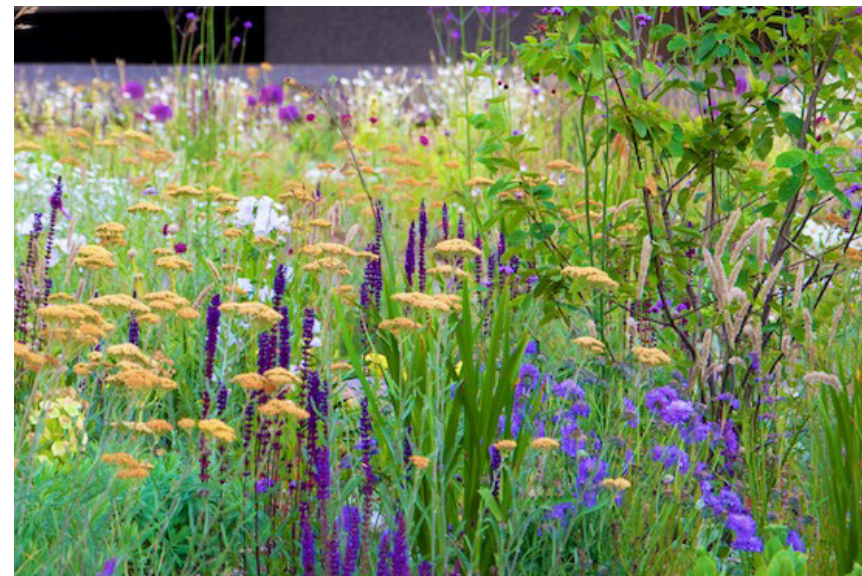

SPRING/SUMMER 2021

EDWARD WOODS ESTATE IMPROVEMENTS



GREATER
LONDON
AUTHORITY



LAND ADJACENT TO HUME HOUSE

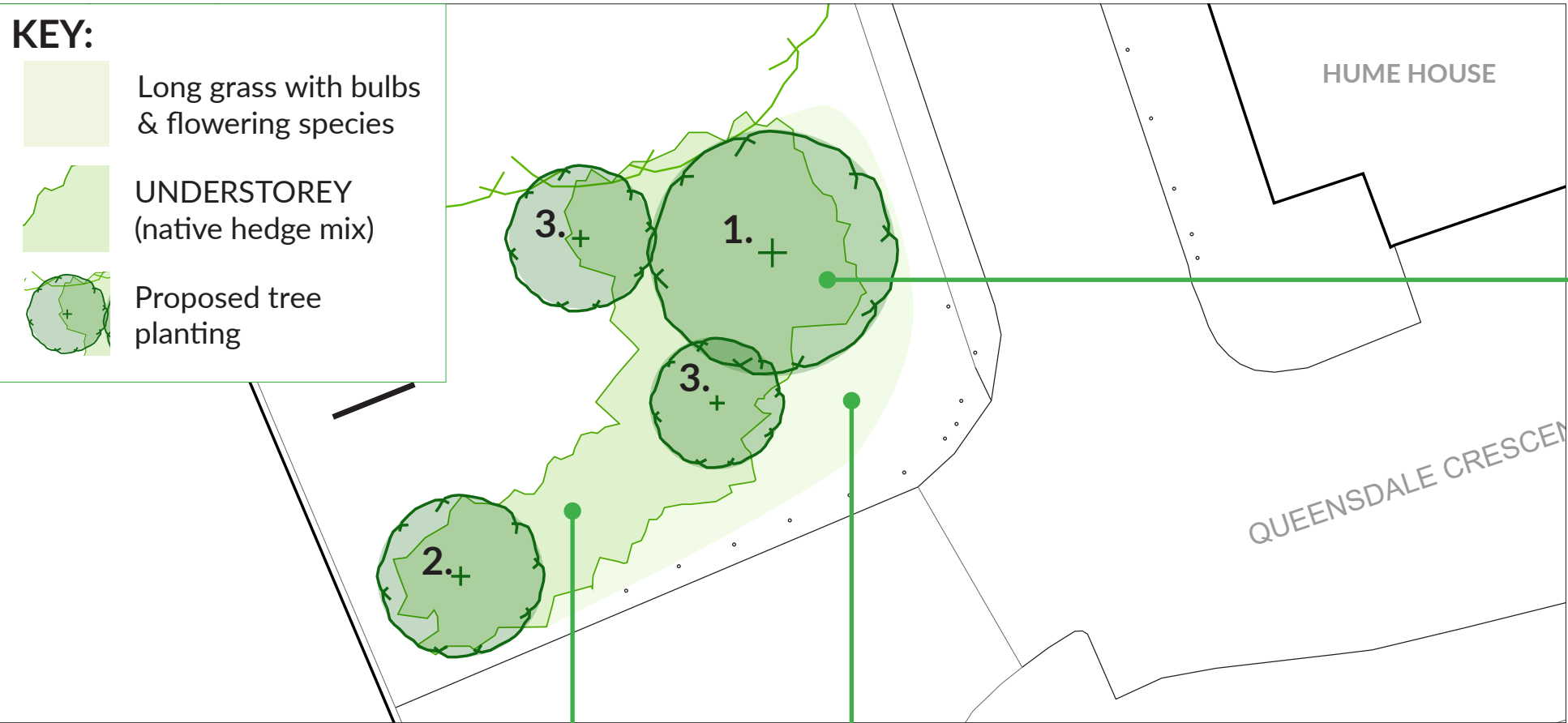

TREES WITH MIXED NATIVE HEDGE/UNDERSTOREY
Provides barrier to particulate pollution from road, plus seasonal interest and biodiversity benefits.



LONG GRASS WITH FLOWERING SPECIES & BULBS
Biodiversity benefits, attractive edge to space. Areas of long grass can be created through changes in maintenance regime, plus improved with additional seed and bulb planting into existing grass.



PROPOSED TREE PLANTING:

Previous feedback identified concerns over air pollution from adjacent roads; by Tree species will be selected on the basis of providing good screening against airbourne pollutants, and biodiversity benefits offered. Types of trees shown on plan are as follows:

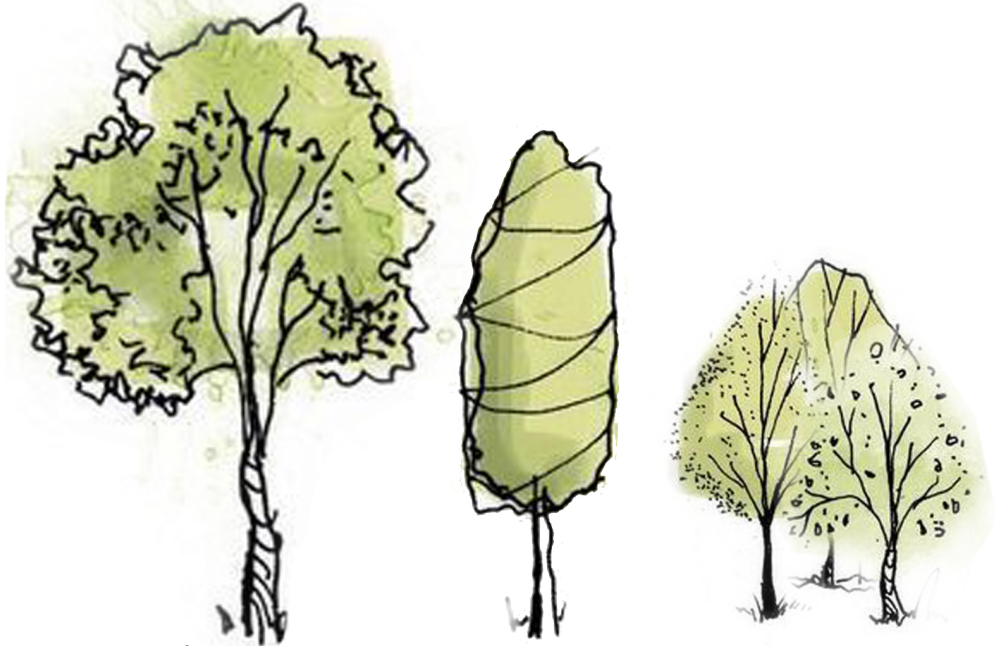

- 1 BROAD/ SPREADING**
Provides maximum canopy cover over wide area to shield flats from pollution
- 2 FASTIGIATE/ UPRIGHT** - height without impeding on sign & highway adjacent. Preferably fast-growing species to provide cover relatively quickly
- 3 SMALL, SHADE-TOLERANT SPECIES**
Additional barrier to pollution, biodiversity benefits. Mixed native species.

Please complete the accompanying questionnaire at:
<https://www.surveymonkey.com/r/EdwardWoodsEstate>
please send us your comments by: 30th June 2021