

1. GENERAL ARRANGEMENT PLAN - PLANTERS
1:500 @ A1

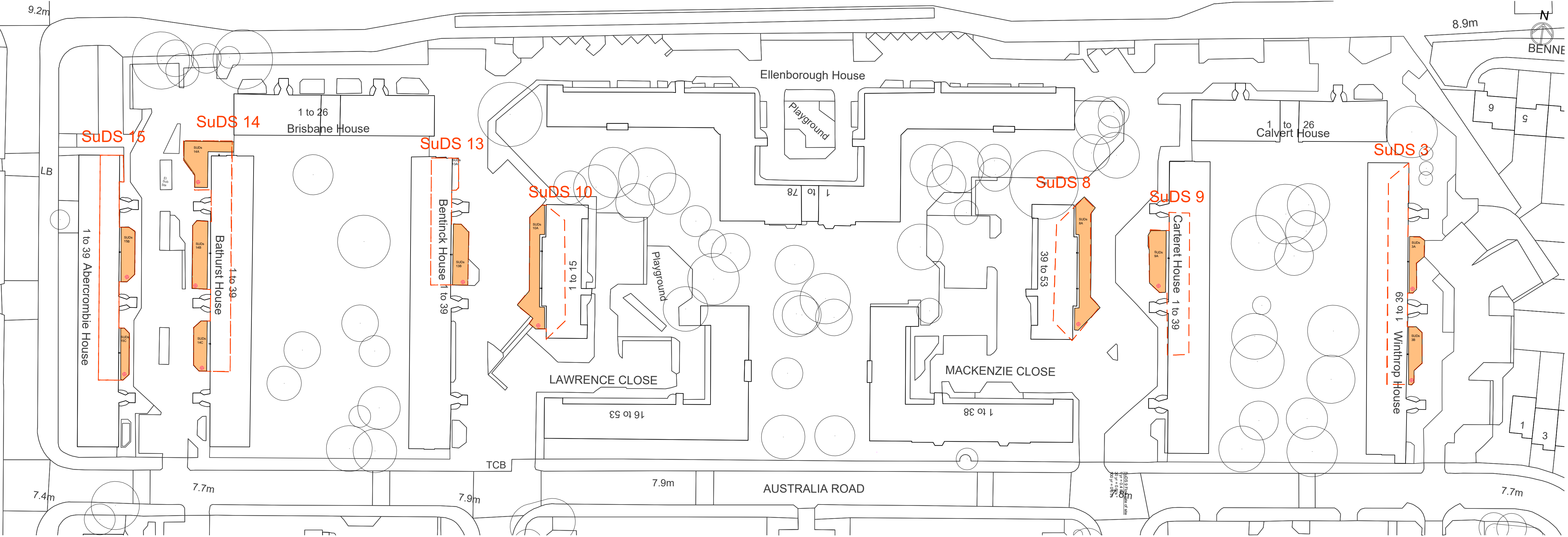

- KEY - planters**
- SuDS catchment area
refer to build programme
 - Flow-through planters - Refer to detail drawings
HF163-NWC-2C-TD-01 & HF163-NWC-2C-TD-02
 - Existing source point & proposed drainage connection
Refer to drawing HF163-NWC-2C-TD-02 for details
 - Control chamber with outfall to CSN
Location TBC subject to site survey/location of existing services
Refer to drawing HF163-NWC-2C-TD-01 for details. **R12 437**

- GENERAL NOTES:**
- All dimensions in metres, unless otherwise noted.
 - Do not scale from plan.
 - Dimensions are to be checked by the contractor prior to commencement of work. Discrepancies shall be reported immediately to Groundwork.
 - Drawing based on topographical survey 1232018 (Drawing commissioned by LBHF and produced by Sitech).
 - Co-ordinates based on OS grid.
 - Levels based on OS datum (Newlyn).
 - This drawing is to be read in conjunction with all other relevant drawings and specifications.
 - All work shall be carried out in accordance with London Borough of Hammersmith & Fulham statutory authority and health & safety requirements and regulations.
 - The position of services is based on information provided by other parties at the time of design and is for guidance only. It is the responsibility of the Client and Contractor to verify the exact position of any services before commencing works on site.
 - These drawings have been produced under the CDM 2015 Regulations.
 - The client is directed to their duties under Regulation 4 of CDM 2015.
 - The delivery of this drawing in electronic format shall not be construed to provide any authorisation or right of the recipient or any other person to rely upon, alter or otherwise use the information provided. Any use of this information is at the sole risk and liability of the user and Groundwork assumes no liability for unauthorised use or alteration of the information contained herein.
 - NEED NOT CARE IS REQUIRED TO ACHIEVE FINISHED SuDS LEVELS AND THE USUAL TOLERANCES DO NOT APPLY. Refer carefully to detailed drawings and ensure that operatives understand the construction of each device type.**

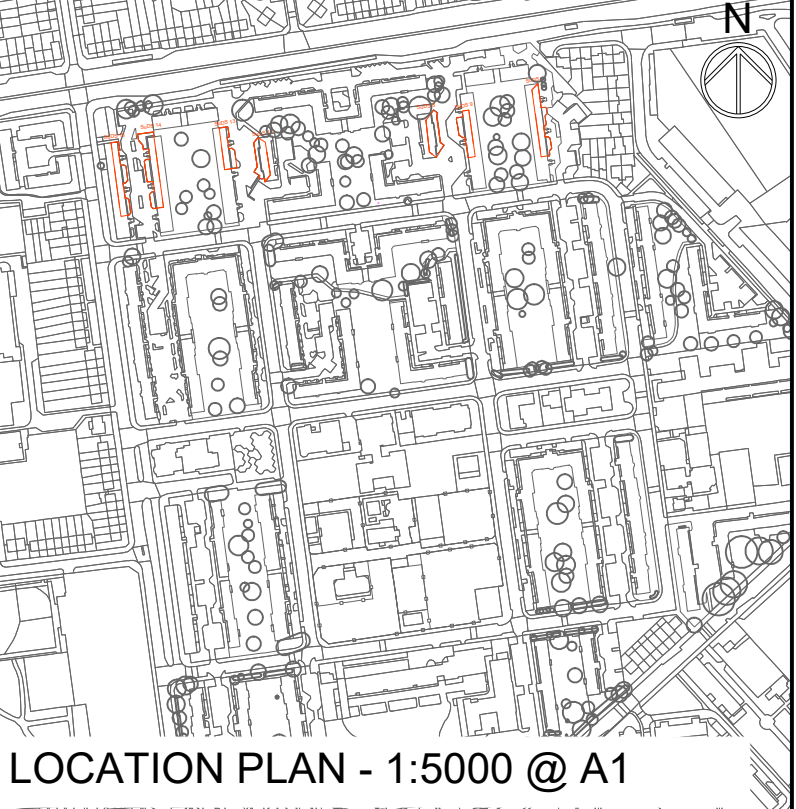

1. SCHEDULE: Planter fill depths and areas

SuDS area	Device	Local Block	EXISTING				PROPOSALS									
			area of planter (m ²)	length (internal face) planter wall (lin.m)	excavation depth		Excavation volume (m ³)	aggregate fill*		growing medium		75mm layer mulch (m3)	1:30yr water depth (mm)	1:30yr water depth (m)	gap (top of planter to growing medium) (mm)	gap (top of planter to control chamber cover level) (mm)
					mm	m		depth (mm)	vol (m ³)	depth (mm)	vol (m ³)					
3	A	Calvert	27.4	27.5	760	0.76	20.8	225	6.2	435	11.9	2.1	225	0.23	100	80
	B	Calvert	29.4	27.4	550	0.55	16.2	150	4.4	300	8.8	2.2	225	0.23	100	80
8	A	Carteret	84.7	63.4	810	0.81	68.6	300	25.4	410	34.7	6.4	131	0.13	100	80
9	A	Lawrence House	46.9	31.0	760	0.76	35.6	250	11.7	410	19.2	3.5	215	0.22	100	80
10	A	Bentick	73.6	61.4	700	0.70	51.5	200	14.7	400	29.4	5.5	122	0.12	100	80
13	B	Bathurst	54.0	30.5	550	0.55	29.7	150	8.1	300	16.2	4.1	224	0.22	100	80
14	A	Abercrombie	54.9	38.4	550	0.55	30.2	150	8.2	300	16.5	4.1	159	0.16	100	80
	B	Abercrombie	48.7	34.0	600	0.60	29.2	160	7.8	340	16.6	3.7	159	0.16	100	80
	C	Abercrombie	29.7	24.4	520	0.52	15.4	120	3.6	300	8.9	2.2	159	0.16	100	80
15	B	Abercrombie	33.7	26.6	580	0.58	19.5	180	6.1	300	10.1	2.5	231	0.23	100	80
	C	Abercrombie	19.2	23.2	610	0.61	11.7	210	4.0	300	5.8	1.4	231	0.23	100	80

Rev	Description	Drawn	Check	Appr	Date
Groundwork London 12 Baron Street London N1 9LL Tel: 020 7239 1280 Fax: 020 7278 1515 www.groundwork.org.uk/london					
 CHANGING PLACES CHANGING LIVES					
Project: NOURISH - WHITE CITY					
Title: Phase 2C GA plan					
Drawn: Check: Appr: Date: Scale at A1: RL KI JE 31/05/2019 1:500		Status: TENDER			
Drawing No: HF163-NWC-GA-2C-01		Revision: -			

DRAWING TO BE PRINTED/READ IN COLOUR