



# GROUNDWORK YORKSHIRE LANDSCAPE ARCHITECT IMPACT REPORT 2022/23



# FOREWORD

**At Groundwork Yorkshire we are passionate about creating a future where every neighbourhood is vibrant and green and able to shape its own destiny, where every community is strong and no-one is held back by their background or circumstances.**

We can only achieve this by working in partnership with others who want to make a difference. Our collective endeavour achieves more than we ever can as individuals. Adding value has been central to Groundwork's way of working since we were first founded and remains central to our mission.

Looking forward, many of our key partners and the communities we serve face an increasingly challenging financial and environmental future. We believe that we can continue to play a role in meeting these challenges, in part thanks to our years of experience but also due to our passion for finding innovative solutions and approaches. I am fortunate to be the Executive Director of Groundwork Yorkshire as I see every day the enthusiasm our great team bring to delivering their projects and programmes.

This impact report highlights some of what Groundwork Yorkshire has achieved in the last year. Many of our programmes and projects have never been needed more than now and I am pleased to report that many of the projects and partnerships highlighted here will continue to evolve in the new year. We will continue to work with individuals, partners and communities to grow human capital and build community resilience.

On behalf of the Trustees and myself I would like to thank our great teams, our many partners and all of those who don't just participate in our projects but enthusiastically help us to continue to Change Places and Change Lives.



A. Curtis

**Adrian Curtis**

**Executive Director**



Groundwork Yorkshire

Landscape Architect Impact Report 2022/23

ABOUT

PARKS

COMMUNITY

GREEN SPACES

AIR QUALITY

# WE'RE PASSIONATE ABOUT A FUTURE WHERE

- > Every neighbourhood is vibrant and green.
- > Every community is strong and able to shape its own destiny.
- > No-one is held back by their background or circumstances.

We help people gain **confidence** and **skills**, get into **training** and work, protect and improve **green spaces**, lead more **active** lives and overcome significant **challenges** such as poverty, isolation, low skills and poor health.



Groundwork Yorkshire

Landscape Architect Impact Report 2022/23

## IMPROVING PEOPLE'S PROSPECTS

Increasing confidence, health and wellbeing, skills and employability of those most in need, lifting them out of poverty.

## CREATING BETTER PLACES

Helping people work together to make their surroundings greener, safer and healthier; getting involved in local decision making.

## PROMOTING GREENER CHOICES

Helping people, communities and businesses understand and reduce their environmental impact to fight climate change.



ABOUT

PARKS

COMMUNITY

GREEN SPACES

AIR QUALITY

# THE YEAR IN NUMBERS 2022-23

## GROUNDWORK YORKSHIRE



**8,459**

People helped to reduce their energy use.  
Tackling fuel poverty and climate change



**389 Ha**

Landscape restored  
= 544 football pitches.  
Tackling the climate & biodiversity crisis



**1,726**

Trees planted.  
Improving access to nature



**331**

Community groups supported. Building pride of place



**12,575**

Hours of volunteer time. Supporting people to be active in communities



**310**

Young people supported to learn, achieve & thrive



**161,127**

People benefitting from our public space improvements



**194**

Schools, businesses & SMEs supported with potential cost savings of £188,484



**188**

Projects delivered, bringing benefits to the people of Yorkshire



Groundwork Yorkshire

Landscape Architect Impact Report 2022/23

# LANDSCAPE ARCHITECTS

Groundwork Yorkshire's qualified **Landscape Architects** are passionate about creating better spaces and have a unique set of skills to bring together community engagement and quality design. Staffed by Chartered Landscape Architects, the team is dedicated to delivering imaginative and innovative design solutions to meet clients' needs.

**82**

projects delivered

**5**

community consultations

**595**

trees planted

**62,255m<sup>2</sup>**

of land Improved

## Public realm and urban design

We design and deliver schemes to develop, enhance and improve urban public spaces.

## Recreation, sport and play facilities

Our work includes the preparation of projects ranging from conceptual masterplans through to contract delivery for local parks, play areas, skate parks, country parks and route ways.

## Community spaces

We are involved with a wide range of projects including schools, churchyards, community gardens and pocket parks, where the primary aim is enhancing spaces and places for the benefit of local communities.

## Blue and green infrastructure

Projects where waterways, drainage, sustainable urban drainage schemes and wetlands are an important or even central part of these schemes. Such projects can be great ways to enhance biodiversity whilst also creating sustainable access routes.

## Public and private housing

We work with a number of social landlords to regenerate the external environment of their estates.

## Climate resilience

We design interventions to deliver a range of benefits such as improving air quality around schools, natural flood management solutions, tree planting and sustainable urban drainage projects.



Groundwork Yorkshire

Landscape Architect Impact Report 2022/23

# PARKS

## MORLEY TOWNS FUND

After the successful Towns Fund Bid to central government, Morley secured £24.3m to deliver projects to transform the town. Part of this funding has been earmarked for the greener and connected programme which includes:

- ✓ The development of **eight parks**
- ✓ The redesign and upgrade of a number of **pocket parks**
- ✓ Better **facilities** for pedestrians and cyclists
- ✓ Improved **connections** to the rail station
- ✓ Improving the **civic space** around the Grade I listed Morley Town Hall

All projects will be completed by March 2026

Our Landscape Architects are leading on the delivery of the first three of these projects. Masterplans were developed for eight parks to help secure the funding and these are being further consulted upon, detailed and delivered in phases over the next four years.

The project so far, has been very well received by the client and residents and several consultation events have taken place to inform the proposals, both online and face to face. Final plans were produced in partnership with the Council and the Greener and Connected Sub Group for 2022/23 for the first two of these parks, Hembrigg and Dartmouth Parks, as well as proposals for Magpie Lane pocket park.

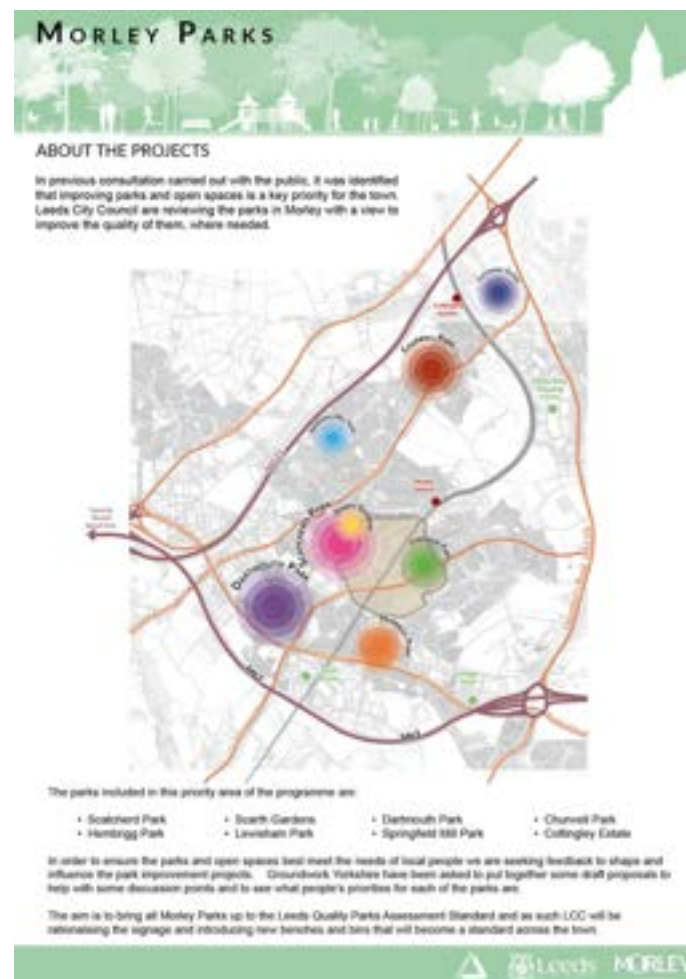

Groundwork Yorkshire

Landscape Architect Impact Report 2022/23



# PARKS

## HEMBRIGG PARK

As part of the Morley Towns Deal, Hembrigg Park was the first park to start onsite. Hembrigg Park has had:

- ✓ Footpaths and the lower car park resurfaced
  - ✓ New searing with wear pads throughout
  - ✓ New woodland walk
  - ✓ Tree planting with a mini orchard
  - ✓ Bulb planting
  - ✓ New wildflower meadow
- 🌲 39 trees planted including 22 fruit trees      🌳 34,942m<sup>2</sup> of park improved

All the planted trees were crown lifted and understorey planting thinned to allow views throughout the space. A new timber fence was also installed to replace the broken one which runs along the fall in level to the north of the site. The fitness station and renewed play area is still to be completed at the end of March 2023.

Feedback from residents has been positive and several public consultations took place to gauge thoughts on the proposals.

A community event also took place inviting people of all ages to come down to the park and draw their proposals for the mural on the side of the changing rooms. This will be included in the next phase of works along with the main entrance feature off Britannia Road.



Groundwork Yorkshire

Landscape Architect Impact Report 2022/23

# PARKS

## DARTMOUTH PARK

As Dartmouth falls within a conservation area, it has been developed in phases to allow the necessary time for consultation and permissions for redevelopment.

One of the concerns at Dartmouth Park was the overgrown vegetation and lack of views through the formal pavilion gardens, making it feel secluded. To open the space, the overgrown understorey planting within the two central green spaces have been removed and more appropriate ornamental planting has been planted in its place.

The small planting beds within the spaces have also been combined into one large, easier to maintain bed. This ensures that all hiding places are removed and users can feel safer when walking through the gardens.



## REIN PARK

The team worked at Rein Park in Seacroft, Leeds to improve the play area and create a pump track for the community.

The installed play area was complimented by a tree and bulb planting scheme to link the different areas. **14 Birch trees** were planted and large swaths of daffodil and snowdrop bulbs, helping to improve **608m<sup>2</sup> of land**.

We also worked alongside Leeds City Council and the LS14 Trust to develop and deliver the **Rein Park Pump Track** in Seacroft, Leeds. It was funded by Section 106 money and **improved 1,300m<sup>2</sup> of land** in the park. The all-weather tarmac course is complimented by a drainage system on this traditionally very wet site. The track has been a huge hit in the local community and complements other facilities in the park.



Groundwork Yorkshire

Landscape Architect Impact Report 2022/23



# PARKS

## ASHTON ROAD PLAY AREA

Leeds City Council approached us to improve Ashton Road play area which was run down and badly in need of repair.

It has been given a new lease of life with a new multi-unit, swings, an activity trail and games markings, along with new play carpet surfacing.

The bland hard space has been softened with new tree planting and ornamental planting in a new raised planter, which doubles as seating. An Ivy green screen has been fixed to the perimeter fencing, adding to the urban oasis feel.

  
**16**  
trees planted

  
**3,588m<sup>2</sup>**  
of land Improved

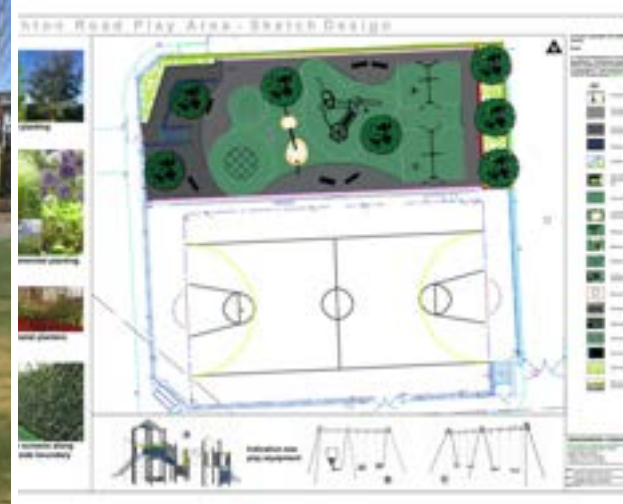

Groundwork Yorkshire

Landscape Architect Impact Report 2022/23

# PARKS

## LEEDS LEVELLING UP FUND (LUF)

We worked with Leeds City Council as part of the Levelling up Fund (LUF) to improve parks across Leeds. The work was part of the Parks and Green Spaces Strategy 2022-2032, to improve parks and green spaces across the city, supporting the Council's Business Case submission to Central Government.

We worked to encourage community use, inclusion and improve health and well-being and worked to provide a host of benefits to the local communities such as; new trees, wildflower planting, new skate parks and multi-use games areas including improvements to play areas, sculpture trails, new artwork and new and improved community spaces.

### The parks involved are:

- > Western Flatts Cliff Park
- > Stanningley Park
- > Armley Park
- > Bramley Fall Park
- > Kirkstall Abbey Park

In addition we also worked on Leeds Central, the Elmet to Rothwell bid and St Matthews in Holbeck.



The memorial garden will be enhanced with the introduction of a path and a central feature. This central feature, comprising of a central stone of evergreen, clipped, low hedging with traditional trees and flowers placed in between, will give colour and interest through the spring/summer. Evergreen hedges will also be introduced, which will grow over time to the planting. These trees will create a canopy over the path, contrasting with the best green spring season. They also introduce a sense of privacy from the surrounding area. Evergreen planting will ensure that the garden has a year-round interest and appeal.

Pathways provide an easy place to walk or jog, for commuters with pushchairs, whilst walking the beauty of the flowers and design.



The existing park is to be improved in the south-east corner. In its place, a landscaped garden is proposed for local events and recreation to play in. This along with the new play area will create a sense of place and a space for the community. The planting of trees and shrubs will create a canopy over the path, contrasting with the best green spring season. They also introduce a sense of privacy from the surrounding area. Evergreen planting will ensure that the garden has a year-round interest and appeal.

Leeds West Parks ARMLEY PARK



Groundwork Yorkshire

Landscape Architect Impact Report 2022/23

# COMMUNITY

## BERYL BURTON GARDENS

The garden was created to celebrate the achievements and life of Morley born cyclist Beryl Burton.

However, the garden, which is overlooked by an impressive mural of her, is dominated by cars and full of uneven paving and tired seating. It is not a space that is welcoming and makes you want to rest there, even though the trees offer shade on a hot day.

Three proposals were presented to the client looking at how this space might be transformed by removing all, some, or none of the existing disabled parking bays. To accompany this a document showing possible areas to relocate the bays was presented to Highways for consideration.

The proposals also extend to the area outside of the Groundwork Morley offices as the two spaces were implemented at the same time.



A new pocket park filled with new raised colour and seating  
Seating under the dropped shade of more appropriate sized trees  
New paving line of bricks and clear routes



Large trees removed to open space up and make it brighter and more inviting and the paving and seating made safe  
Seating incorporated into wall seating  
Revised parking on Morley Road Avenue with parking to select off Queen Street  
Change in surface and level to road to slow traffic and visually link the two spaces



Good visibility across the site with low level planting and clear signs on the trees  
Large seating area for sale for benches to sit away from cars  
New raised planters offer space for incredible Beryl Burton and others to continue to plant for community use



# COMMUNITY

## COBBLERS LANE, PONTEFRACT

The Environment Agency asked Groundwork to administer monies from an environmental fine, to carry out improvements within Pontefract. An overgrown area of land between houses used by residents as a cut through was chosen as it was dark and overgrown, uneven underfoot and anti-social behaviour was taking place there.

Working with Wakefield District Housing, the trees were crown lifted, understorey thinned, the full site cleared of litter and waste. We laid a new all-weather footpath, sowed species rich grass seed and created log piles to encourage wildlife and reduce the mowing regime on the site. This allowed children who used the route as a cut through to school to feel safe and seen when using the path.

  
**7,710m<sup>2</sup>**  
of land Improved



## BARLEY HILL

A great community project installed by Groundwork Pride team, creating something a little different than usual at Barley Hill in Garforth. The space provides a safe, colourful place for the community to enjoy and includes a story telling area, picnic tables, and soft landscaping.



**Five** trees planted



**200m<sup>2</sup>** of land improved



Groundwork Yorkshire

Landscape Architect Impact Report 2022/23

ABOUT

PARKS

COMMUNITY

GREEN SPACES

AIR QUALITY

# COMMUNITY

## BURLINGTON AVENUE POCKET PARK

Groundwork transformed Burlington Avenue in Bradford as part of the Better Start Bradford project.

The large area of land was previously open and vulnerable to anti-social behaviour. It is now protected with an artistic perimeter knee rail and has attractive playful features including portal stones, carvings and stepping stones, serving a purpose to the community. There is a boardwalk and wetland swale, along with new trees, shrub planting and wildflower areas.

✓ 14 trees planted

✓ 956m<sup>2</sup> of land improved



## MAGPIE LANE

Magpie Lane's green space had been used as a cut through by residents over a number of years, so a small project was created as part of the Morley Town Funds Programme to formalise the desire lines, create new seating areas and introduce new tree planting to soften the space.

✓ Nine trees planted

✓ 4,500m<sup>2</sup> of land improved for residents



Groundwork Yorkshire

Landscape Architect Impact Report 2022/23



# GREEN SPACES

## WHITEHALL RIVERSIDE POCKET PARK

Whitehall Riverside in Leeds was a narrow stretch of unused land between the River Aire and the Leeds and Liverpool Canal. This land is overlooked by existing and proposed development and had become a site full of weeds and used by rough sleepers. The adjacent towpath is also one of the busiest in the UK by and for jogging, pedestrians and cyclists.

In partnership with Leeds City Council, Canal and River Trust, Network Rail (and Groundwork Pride Ltd), we have reinvigorated the derelict land to provide an alternative path, providing a 'slower' route, seating and planting with views of the wildlife on the Aire and access to the visiting swans.

On Friday 31st March, the park was officially opened with a community event, inviting local councillors and those who have helped to make the space a success.



16 trees planted



3,588m<sup>2</sup> of land improved



Groundwork Yorkshire

Landscape Architect Impact Report 2022/23

ABOUT

PARKS

COMMUNITY

GREEN SPACES

AIR QUALITY



# GREEN SPACES

## MORLEY GREENWAY

As part of the Green and Connected element of the Morley Town Investment Plan, Leeds City Council approached Groundwork Yorkshire to design and help deliver the upgrading of a greenway. The route will link Morley and Cottingley, incorporating a cycleway. A feasibility survey was put together and presented to the client and Subgroup. This will continue to be developed throughout 2023/24.



## PARKLAND FIELDS

A drainage improvement scheme in Seacroft to tackle the water retention issue on a football field. A soak away was installed to carry excess water away from the site. A knee-high fence was installed along the north side of the park, and 15 small to medium sized trees were planted.



## COMMON LANE, THORPE AUDLIN

Groundwork Yorkshire was approached by White Rose Forest to detail and deliver the planting of native trees and hedging on Common Lane in Thorpe Audlin. It was part of a Yorkshire programme for woodland creation, one of the most competitive and flexible funding packages for tree planting available to landowners. The projects across North and West Yorkshire benefitted from over £7.5 million of government funding for the planting of new trees and woodland.



Planted across **1,850m<sup>2</sup>**



**417** trees planted



**125 lin m** of native hedge



Groundwork Yorkshire

Landscape Architect Impact Report 2022/23

# GREEN SPACES

## DYNAMIC DRAINS

Groundwork Hull's Dynamic Drains project has been running for three years in partnership with Hull City Council, Yorkshire Wildlife Trust and Environment Agency. The project aims to increase biodiversity along the man-made three and a half mile stretch of the Beverley and Barmston Drain. The team also work to improve the water quality, engage the local community in nature and collective action to address issues such as littering and fly tipping.

Green Recovery Challenge Fund

Department  
for Environment  
Food & Rural Affairs

The National Lottery  
Heritage Fund

Environment  
Agency

NATURAL  
ENGLAND

Hull  
City Council

Yorkshire  
Wildlife Trust

## THORPE PARK ROAD

Thorpe Park Road Pocket Park in Hull was completed mid-March, consisting of a new footpath running adjacent to the Barmston Drain, a seating area, portal stone and native tree planting. The footpath is already well used and is accessible for all, enabling everyone to take this greener route, which was previously used as a short-cut across the grass. Bulb planting will take place in the autumn, supported by the Hull Green Team.



Nine trees planted



2,053m<sup>2</sup> of land improved



## CLOUGH ROAD

The site runs adjacent to the Barmston and Beverley Drain and next to a shopping arcade at the junction of Clough Road and Scissons Way. There has been no former connection between the shopping arcade and Barmston Drain which was identified as a potential amenity area.

We installed **six picnic tables and seats** alongside the existing footpath along the drain to open up a community space. Barmston Drain has been accessed with a series of steps leading to a **pond dipping platform**.



Groundwork Yorkshire

Landscape Architect Impact Report 2022/23

# AIR QUALITY

## AIR QUALITY SCHOOLS

We began phase two of our air quality improvement scheme around five schools in Bradford. The schools are located close to busy roads, potentially causing harm from the fumes from car exhausts. Specific species of trees were selected that are proven to catch the finest particles to help reduce harm to human health.

### We worked at:

- > Byron Primary School
- > Fearnville Primary School
- > Killinghall Primary School
- > Lower Fields Primary Academy
- > Westminster C of E Primary Academy

- ✓ 385.3 lin m - Thuja plicata - Western Red Cedar hedging
- ✓ 150.5 lin m - Hedera helix - Ivy screen planting
- ✓ 32 trees planted



Groundwork Yorkshire

Landscape Architect Impact Report 2022/23



# THANK YOU!





Working in partnership with public, private and community stakeholders, we improve, protect and enhance our local communities, partners and environment. A wholehearted THANK YOU is extended to all the organisations and people we have worked with in 2022/23.

## LANDSCAPE ARCHITECT IMPACT REPORT 2022/23 GROUNDWORK YORKSHIRE

Visit: [www.groundwork.org.uk/yorkshire](http://www.groundwork.org.uk/yorkshire)

Email: [leeds@groundwork.org.uk](mailto:leeds@groundwork.org.uk)

Telephone: 0300 3033 292

-  @GroundworkYorks
-  @GroundworkYorkshire
-  @Groundwork In The North
-  @groundworkyorkshire
-  @Groundwork Yorkshire

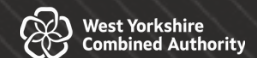

Groundwork Yorkshire is a company limited by guarantee and registered in England.  
Company Registration Number: 2202681 Charity Registration No: 519846  
Published February 2024